

Plumer Street, Wavertree, L15



To Let - £770 per calendar month

Key Features

- 2 Bedroom 1 Bathroom Terraced House
- EPC Rating: D
- Attractive End Terrace
- Available for Long Term
- Located in the Popular Residential Location of Wavertree
- Central Heating
- Double Glazing
- Close to Local Amenities
- Early Viewing Advised!
- Good Public Transport Links
- Freshly Decorated
- 10 Minute Drive to City Centre

Move-in Costs

- Security Deposit: £888.46
- To secure this property you are required to pay a holding deposit equal to one weeks rent, £177.69. The holding deposit will go on to form part of your rent/security deposit. The balance of any rent/security deposit is normally payable the working day before you move in.

Description

Atlas Estate Agents proudly presents this delightful terraced house for rent in the popular residential location of Wavertree.

This attractive end terrace, offers a warm and inviting atmosphere with freshly decorated interiors. The accommodation, arranged over two floors, comprises a well-appointed kitchen, a cozy reception room, two bedrooms, and a bathroom - providing a perfect blend of practicality and charm.

Ideal for those seeking a long-term residence, this property comes unfurnished, allowing you to personalize the space to suit your taste and style. Central

Further Details

- Furnishing: Unfurnished
- No. of Floors: 2
- Floor Space: 52 square metres / 560 square feet
- Council Tax Band: A
- Local Authority: Liverpool City Council
- Parking: On Street
- Outside Space: Back Yard
- Heating/Energy: Gas Central Heating, Double Glazing
- Appliances/White Goods: Oven (Electric), Hob (Ceramic)
- Bills Included: None

Letting Information

- Date Available From: Now
- Minimum Annual Household Income: £23,100
- Guarantor NOT required (subject to referencing)

heating and double glazing ensure a comfortable living environment throughout the year, while the proximity to local amenities and good public transport links make daily life a breeze.

Located just a 10-minute drive from the bustling City Centre, you'll enjoy the perfect balance of suburban tranquility and urban accessibility. Early viewing is advised to secure this gem, as opportunities like this are rare.

Don't miss the chance to make this terraced house your home - contact Atlas Estate Agents today and embark on a journey to comfortable living in Wavertree!

Additional Images



Floor Plans

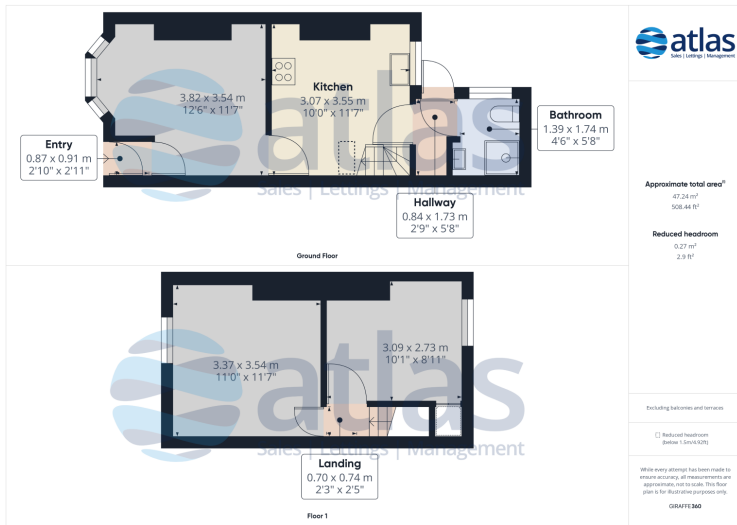

Tel: 0151 727 2469
Fax: 0151 727 4943

Atlas Estate Agents, 2 Allerton Road,
Mossley Hill, Liverpool, L18 1LN

Email: lettings@atlasestateagents.co.uk
Website: www.atlasestateagents.co.uk

These particulars are intended to give a fair and substantially correct overall description for the guidance of intending purchasers/tenants and do not constitute an offer or part of a contract. Please note that any services, heating systems or appliances have not been tested and no warranty can be given or implied as to their working order. Prospective purchasers/tenants ought to seek their own professional advice.

All descriptions, dimensions, areas, references to condition and necessary permissions for use and occupation and other details are given in good faith and are believed to be correct, but any intending purchasers/tenants should not rely on them as statements or representations of fact, but must satisfy themselves by inspection or otherwise as to the correctness of each of them.